

# Ball Valve

## with M10x1 Sensor Socket

**Service friendly sensor replacement**

**Long-life valve with teflon gaskets**

**Program from DN15 to DN25**

**Medium temperature up to 150°C**

**Ready for sealing of sensors**



### Application

---

Ball valves with a M10x1 sensor socket fit short, direct temperature sensors, type DS, in accordance with EN 1434-2.

When the ball valve is in closed position, replacement of the temperature sensor can be made hardly without wasting any water.



Kamstrup A/S  
Industrivej 28, Stilling  
DK-8660 Skanderborg  
TEL: +45 89 93 10 00  
FAX: +45 89 93 10 01  
info@kamstrup.com  
www.kamstrup.com

## Technical data

Medium temperature	0...150°C
Medium	District heating and cooling water
Pressure stage	PN16
Connection	Internal thread according to DS/DIN/ISO 228
Material	Brass, MS 58
Surface, housing	Nickel-plated
Surface, ball	Chromium-plated
Internal gaskets	PTFE (Teflon)



## Dimensions

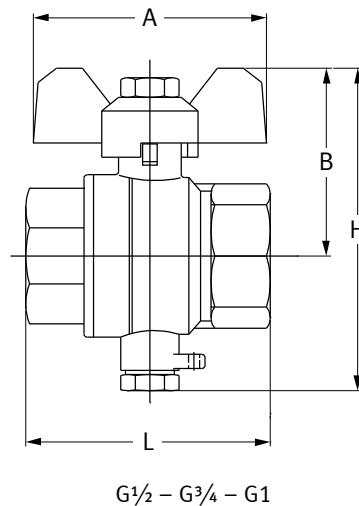

## Type numbers

Type no.	65-56-474	65-56-475	65-56-476
Connection thread	G <sup>1</sup> / <sub>2</sub>	G <sup>3</sup> / <sub>4</sub>	G1
DN [mm]	15	20	25
L [mm]	48	53	66
A [mm]	54	52	64
B [mm]	39	49	54
H [mm]	76	85	94
Width across flats [mm]	25	31	38
Weight [g]	190	260	430

<b>Coupling between ball valve and flow meter</b>	R <sup>1</sup> / <sub>2</sub> - G <sup>3</sup> / <sub>4</sub>	R <sup>3</sup> / <sub>4</sub> - G1	R1 - G5/4
---	---	------------------------------------	-----------